



WINDSHIELD ACC. TO TRETJAKOV

for precipitation sensors

Recommendation of the WMO...

to reduce the measurement error due to wind influence.

In combination with the weighing precipitation sensor rain[e]H3, the Tretjakov windshield is used by the German Weather Service (DWD) at selected locations.

The windshield is equipped with vertically circularly arranged stainless steel blades. These segments are horizontally movable and are conically joined at the base of the precipitation sensor.

The Tretjakov windshield consists of a frame, metal segments and accessories for quick and easy installation.

- durable windshield made of corrosion-resistant V4A stainless steel
- different measuring heights available
- for all common precipitation sensors
- simple installation

professional meteorology and hydrology

- measuring networks of water suppliers
- weather services • airports



rain[e]H3 and windshield in use at DWD

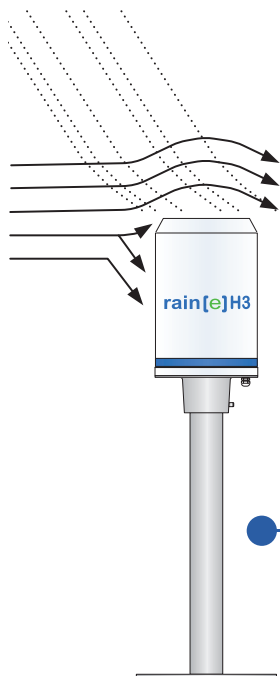
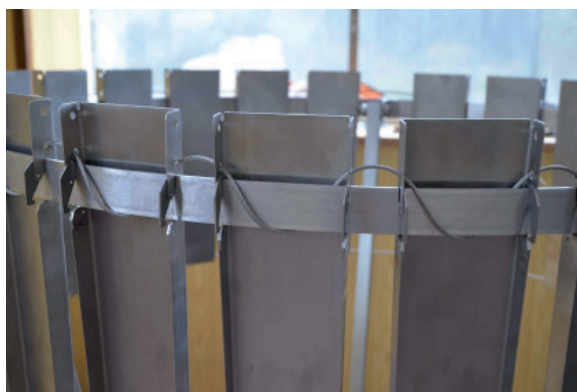

View of the completely installed system with lamella blocking protection (optionally available)

Wind influence without windshield:
The solid lines show stream-lines of the wind. The dashed lines show the trajectories of the precipitation particles.

Dimensions

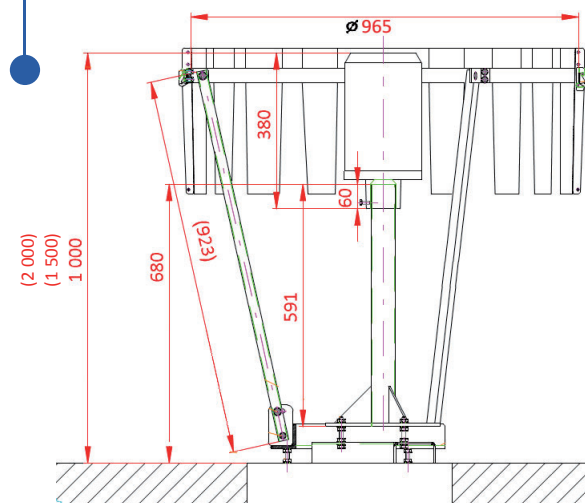

Professional Line

Id-No. 00.15091.600100

Id-No. 00.15091.600150

Id-No. 00.15091.600200

Windshield acc. to Tretjakov for all common precipitation sensors • e.g. rain[e] series

Windshield acc. to Tretjakov • for measuring height 1.0 m

Windshield acc. to Tretjakov • for measuring height 1.5 m

Windshield acc. to Tretjakov • for measuring height 2.0 m