

Plastic valve

Brass valve MH

Brass valve GMV 191-M-1/2

SPARE VALVES:**GMV 191**

Item No. 601664

Spare valve 1/2 inch plastic for 3/4 inch tap assembly

GMV 191-MH

Item No. 482685

Spare valve 1/2 inch brass for 3/4 inch tap assembly

GMV 191-M-1/2

Item No. 482689

Spare valve 1/2 inch brass for pipe mounting

GMV 191-M-3/4

Item No. 482690

Spare valve 3/4 inch brass for pipe mounting

GMV 191-M-1

Item No. 482691

Spare valve 1 inch brass for pipe mounting

SENSORS: WATER SENSOR GWF-1, STANDARD**GWF-1S/2 m**

Item No. 601706

GWF-1S/5 m

Item No. 601708

GWF-1S/10 m

Item No. 601710

SENSORS: FLOAT SWITCH**GSS-1S**

Item No. 603247

Float switch also for electrically non-conductive media, PVC, thread PG 7, 2 m cable

SENSOR EXTENSION CABLE *)**VEKA 2/2 m**

Item No. 601726

VEKA 5/5 m

Item No. 60172

VEKA 10/10 m

Item No. 601731

BRANCH CONNECTOR FOR USING SEVERAL SENSORS *)**GAZ-1**

Item No. 602748

WATER SENSOR**GWF-1**

Item No. 601712

Water sensor, 2-pole, without connector, 2 m cable

VARIANTS:**GWF-1/5m**

Item No. 601717

Water sensor 2-pole, without connector, 5 m cable

GWF-1/10m

Item No. 601723

Water sensor, 2-pole, without connector, 10 m cable

TO GO WITH:

GEWAS 200, GEWAS 300 FG

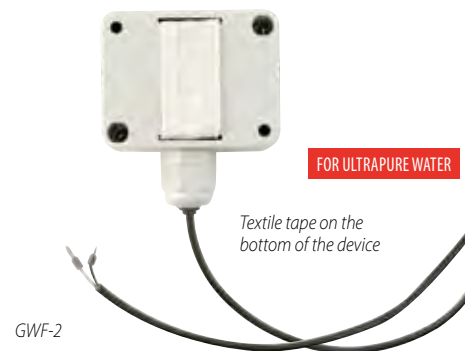

GWF-2

FOR ULTRAPURE WATER

Textile tape on the bottom of the device

GWF-2

Item No. 601778

Textile tape water sensor with loose ends for ultrapure water, 2 m cable

TECHNICAL SPECIFICATIONS:**Housing:**

Made of ABS with two mounting holes and PG screw connection

Dimension:

65 x 35 x 50 mm (L x W x H), without PG screw connection

Scope of delivery:

Device

TO GO WITH:

GEWAS 200, GEWAS 300 FG, GEWAS 300 SP

GWF-2S

Item No. 601779

Textile tape water sensor ready to plug in for ultrapure water, 2 m cable